

KOMBIC 70 DOWNLIGHT

K711523WW827N66

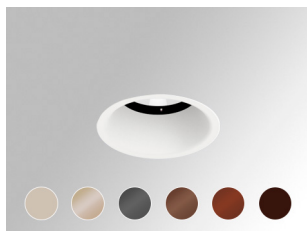

KOMBIC 70 1500 IP23 827 WW SER

Description:

Recessed round downlight model KOMBIC 70. R-PC FR WHITE tm recycled polycarbonate reflector with bromine-free flame retardant. Flammability degree V0 according to UL94. Wall-washer optics, ideal for illuminating vertical planes or areas adjacent to work areas. Aluminum injection heatsink, with a black finish. COB LED, with 2700K color temperature with CRI80. Electronic equipment ON OFF included. With an IP43 degree of protection. Insulation class II. Photobiological safety group 0. Lifespan: 72,000 L80 B10. Available finish SERENA palette (Arena, Bronze, Champagne, Dark Chocolate, Dark Grey, Terracotta). Luminous flux tolerance $\pm 8\%$ depending on the finish.

Finish: SERENA Palette

Weight: 190 g

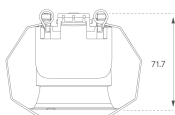
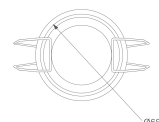

Installation: Recessed

TECHNICAL SPECIFICATIONS:

Light output:	694 lm	°K :	2700
Plum:	10W	CRI :	80
Efficacy:	69,4 lm/w	MacAdam:	3
UGR:	<19	Power Supply:	220-240V 50/60Hz
Type:	COB	Gear:	Electronic
LED Lifetime:	66.000 L90 B10 (Ta=25°C)		
Power:	8,4W		

Light output tolerance +/- 10%

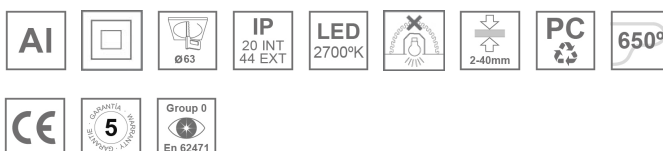

CUSTOM MADE OPTIONS:

