

KOMBIC 70 DOWNLIGHT

K711523WW827DWW

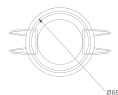

KOMBIC 70 1500 IP43 VWW WW DA WH/WH

Description:

LAMP Round recessed downlight KOMBIC 70 1500 Reflector made of recycled polycarbonate R-PC FR WHITE TM non-brominated flame retardant additive. Flammability grade V0 according to UL94. Wallwasher optic option, suitable for vertical plane lighting or work areas surroundings. Heatsink made of die-cast aluminium with black finish. COB LED, colour temperature 2700K and CRI80. Electronic DALI gear included. IP43 rated. Insulation Class II. Photobiological safety group 0. LED life time: 72.000 L80 B10. Available finishes: White and black.

Finish: Matte white RAL 9010**Weight:** 210 g**Installation:** Recessed**TECHNICAL SPECIFICATIONS:**

Light output:	821 lm	°K :	2700
Plum:	10W	CRI :	80
Efficacy:	82,1 lm/w	MacAdam:	3
Type:	COB	Power Supply:	220-240V 50/60Hz
LED Lifetime:	72.000 L80 B10 (Ta=25°C)	Gear:	Adjustable DALI
Power:	8,4W		

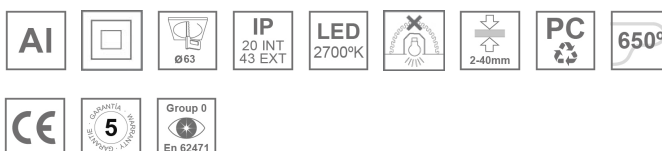
Light output tolerance +/- 10%**CUSTOM MADE OPTIONS:**

KOMBIC 70 DOWNLIGHT

K711523WW827DWW

KOMBIC 70 1500 IP43 VWW WW DA WH/WH

PHOTOMETRIC DATA :

