

KOMBIC 70 DOWNLIGHT

K711523WF930DBB

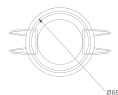

KOMBIC 70 1500 IP43 9WW WFL DA BK/BK

Description:

KOMBIC 70 round recessed downlight by LAMP. Reflector made of recycled polycarbonate R-PC FR WHITE TM non-brominated flame retardant additive. Flammability grade V0 according to UL94. Inner reflector finished in black. Heatsink made of die-cast aluminium with black finish. COB LED, colour temperature 3000K with CRI90. Luminaire with electronic wiring Dali included. Insulation class II. LED life time: 66000 L90 B10. With IP43 degree of protection. Group 0 photobiological safety. Optic Wide Flood to achieve a controlled light distribution and low UGR<16

Finish: Matte black RAL 9011**Weight:** 190 g**Installation:** Recessed**TECHNICAL SPECIFICATIONS:**

Light output:	739 lm	°K :	3000
Plum:	9,5W	CRI :	90
Efficacy:	77,8 lm/w	R9 :	52
UGR:	<16	MacAdam:	3
Type:	COB	Power Supply:	220-240V 50/60Hz
LED Lifetime:	66.000 L90 B10 (Ta=25°C)	Gear:	Adjustable DALI
Power:	8,4W		

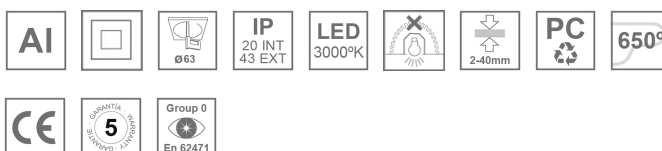
Light output tolerance +/- 10%**CUSTOM MADE OPTIONS:**

KOMBIC 70 DOWNLIGHT

K711523WF930DBB

KOMBIC 70 1500 IP43 9WW WFL DA BK/BK

PHOTOMETRIC DATA :

