

KOMBIC 70 DOWNLIGHT

K711523WF827D66

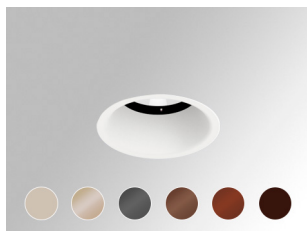

KOMBIC 70 1500 IP43 827 WFL DA SER

Description:

Recessed round downlight model KOMBIC 70. R-PC FR WHITE tm recycled polycarbonate reflector with bromine-free flame retardant. Flammability degree V0 according to UL94. Wide flood optics with light distribution control and UGR<13 glare reduction. Aluminum injection heatsink, with a black finish. COB LED, with 2700K color temperature with CRI80. DALI electronic equipment included. With an IP43 degree of protection. Insulation class II. Photobiological safety group 0. Lifespan: 72,000 L80 B10. Available finish SERENA palette (Arena, Bronze, Champagne, Dark Chocolate, Dark Grey, Terracotta). Luminous flux tolerance±5% depending on the finish.

Finish: SERENA Palette

Weight: 190 g

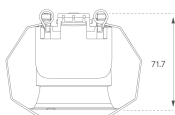
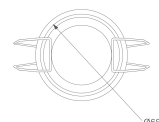

Installation: Recessed

TECHNICAL SPECIFICATIONS:

Light output:	845 lm	°K :	2700
Plum:	10W	CRI :	80
Efficacy:	84,5 lm/w	MacAdam:	3
UGR:	<13	Power Supply:	220-240V 50/60Hz
Type:	COB	Gear:	Adjustable DALI
LED Lifetime:	66.000 L90 B10 (Ta=25°C)		
Power:	8,4W		

Light output tolerance +/- 10%

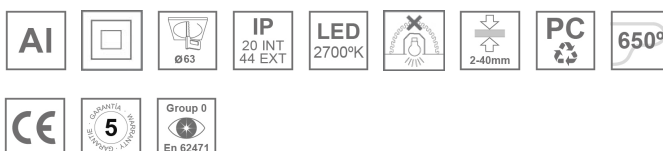

CUSTOM MADE OPTIONS:

