

## KOMBIC 70 DOWNLIGHT

K711523RW840N66

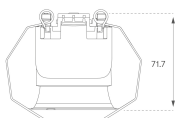
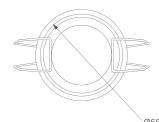
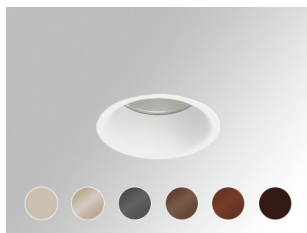

## KOMBIC 70 1500 IP23 840 RF WFL SER

**Description:**

Recessed round downlight model KOMBIC 70. R-PC FR WHITE tm recycled polycarbonate reflector with bromine-free flame retardant. Flammability degree V0 according to UL94. Wide reflector for greater efficiency and control of light distribution and glare reduction UGR<16 Aluminum injection heatsink, with a black finish. COB LED, with 4000K color temperature with CRI80. Electronic equipment ON OFF included. With an IP23 degree of protection. Insulation class II. Photobiological safety group 0. Lifespan: 72,000 L80 B10. Available finish SERENA palette (Arena, Bronze, Champagne, Dark Chocolate, Dark Grey, Terracotta). Luminous flux tolerance  $\pm 4\%$  depending on the finish.

**Finish:** SERENA Palette**Weight:** 190 g**Installation:** Recessed**TECHNICAL SPECIFICATIONS:**

<b>Light output:</b>	966 lm	<b>°K :</b>	4000
<b>Plum:</b>	10W	<b>CRI :</b>	80
<b>Efficacy:</b>	96,6 lm/w	<b>MacAdam:</b>	3
<b>UGR:</b>	<16	<b>Power Supply:</b>	220-240V 50/60Hz
<b>Type:</b>	COB	<b>Gear:</b>	Electronic
<b>LED Lifetime:</b>	66.000 L90 B10 (Ta=25°C)		
<b>Power:</b>	8,4W		

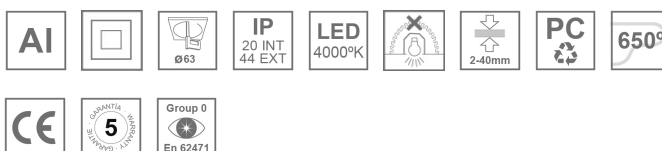
**Light output tolerance  $\pm 10\%$** **CUSTOM MADE OPTIONS:**