

## KOMBIC 70 DOWNLIGHT

K711523RF840NBB

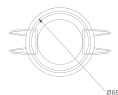

## KOMBIC 70 1500 IP23 NW RF FL BK/BK

## Description:

KOMBIC 70 round recessed downlight by LAMP. Reflector made of recycled polycarbonate R-PC FR WHITE TM non-brominated flame retardant additive. Flammability grade V0 according to UL94. Inner reflector finished in black. Heatsink made of die-cast aluminium with black finish. COB LED, colour temperature 4000K with CRI80. Luminaire with electronic wiring included. Insulation class II. LED life time: 66000 L90 B10. With IP23 degree of protection. Group 0 photobiological safety. Reflector Flood to achieve a controlled light distribution and low UGR<16

**Finish:** Matte black RAL 9011

**Weight:** 190 g

**Installation:** Recessed

## TECHNICAL SPECIFICATIONS:

<b>Light output:</b>	1.080 lm	<b>°K :</b>	4000
<b>Plum:</b>	9,5W	<b>CRI :</b>	80
<b>Efficacy:</b>	113,6 lm/w	<b>MacAdam:</b>	3
<b>UGR:</b>	<16	<b>Power Supply:</b>	220-240V 50/60Hz
<b>Type:</b>	COB	<b>Gear:</b>	Electronic
<b>LED Lifetime:</b>	66.000 L90 B10 (Ta=25°C)		
<b>Power:</b>	8,4W		

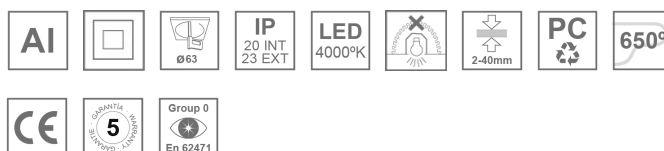
*Light output tolerance +/- 10%*

## CUSTOM MADE OPTIONS:



KOMBIC 70 DOWNLIGHT

K711523RF840NBB

KOMBIC 70 1500 IP23 NW RF FL BK/BK

PHOTOMETRIC DATA :

