

KOMBIC 70 DOWNLIGHT

K711523EL927D66

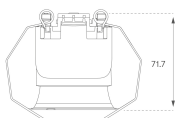
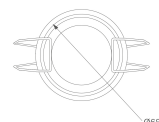
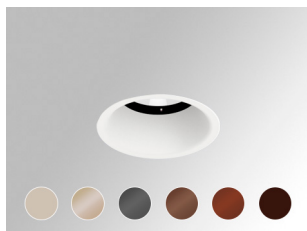

KOMBIC 70 1500 IP23 927 EL DA SER

Description:

Recessed round downlight model KOMBIC 70. R-PC FR WHITE tm recycled polycarbonate reflector with bromine-free flame retardant. Flammability degree V0 according to UL94. Elliptical optics, which increase the distance between luminaires and reduce the effect of residual light on the walls. Ideal for lighting passageways, longitudinal areas such as countertops or areas adjacent to work areas Aluminum injection heat sink, with a black finish. COB LED, with 2700K color temperature with CRI90. Electronic equipment DALI included. With an IP43 degree of protection. Insulation class II. Photobiological safety group 0. Hours of life: 66,000 L90 B10. Available finish SERENA palette (Arena, Bronze, Champagne, Dark Chocolate, Dark Grey, Terracotta). Luminous flux tolerance $\pm 4\%$ depending on the finish.

Finish: SERENA Palette**Weight:** 190 g**Installation:** Recessed**TECHNICAL SPECIFICATIONS:**

Light output:	794 lm	°K :	2700
Plum:	10W	CRI :	90
Efficacy:	79,4 lm/w	R9 :	58
UGR:	<19	MacAdam:	3
Type:	COB	Power Supply:	220-240V 50/60Hz
LED Lifetime:	66.000 L90 B10 (Ta=25°C)	Gear:	Adjustable DALI
Power:	8,4W		

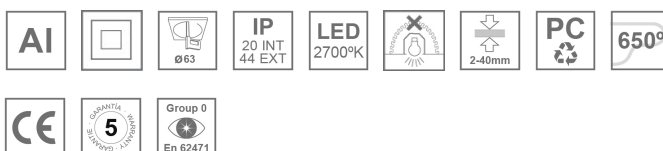
Light output tolerance $\pm 10\%$ **CUSTOM MADE OPTIONS:**